

Government Road Allowance

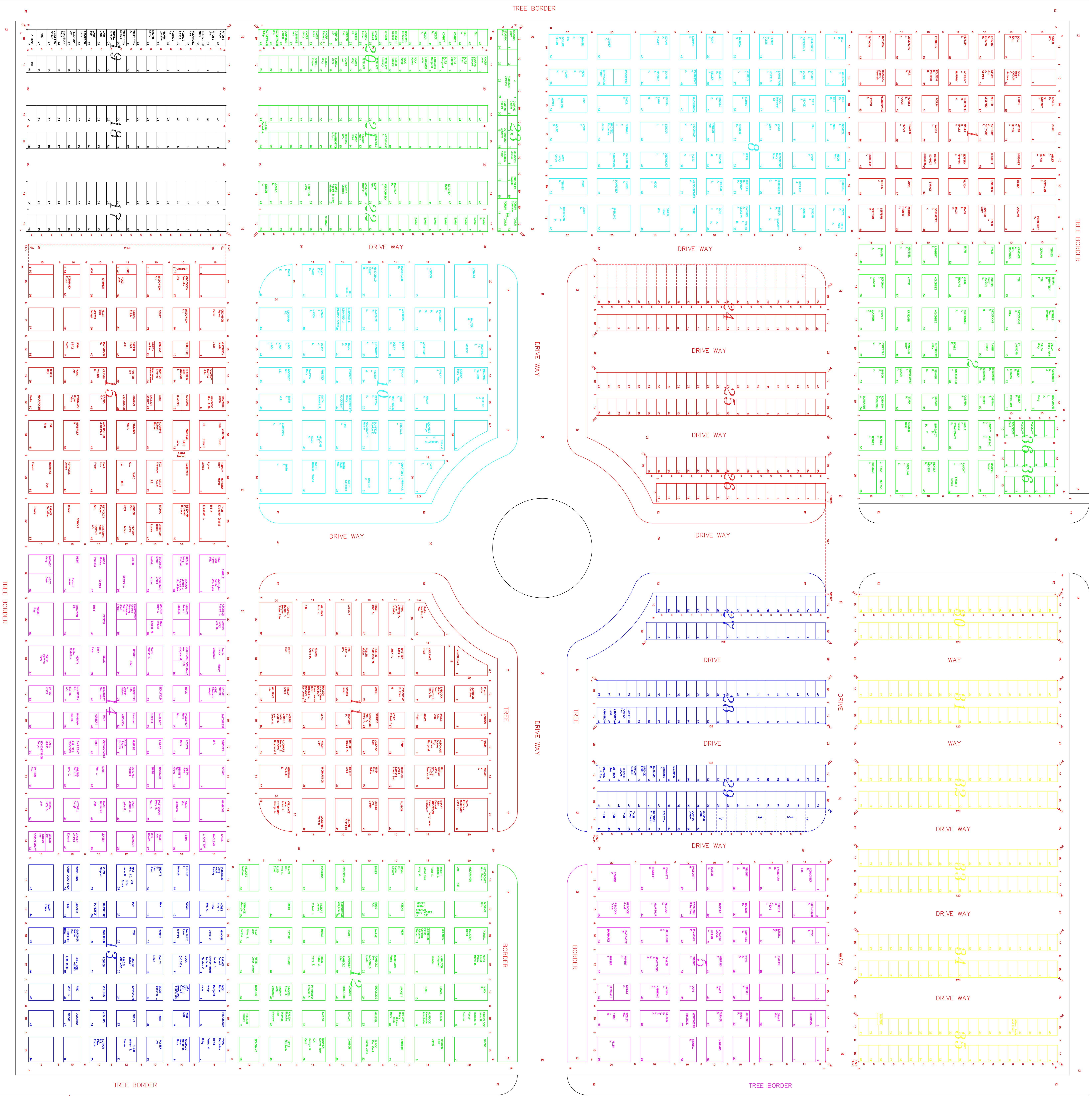

Plan of Survey Showing
 Plot of
KERROBERT CEMETERY
 in
 N.E. 1/4 Sec. 10-31-23-3
 SASKATCHEWAN
 By: S.I. Hayward S.L.S.
 1987 - 1992
 Scale: 1" = 20'

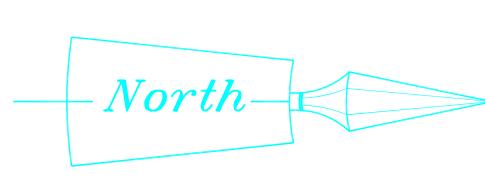

NOTE: This plan was prepared by the Surveyor General of Saskatchewan, S.I. Hayward, S.L.S., on the basis of a plan of survey filed in the office of the Surveyor General of Saskatchewan, S.I. Hayward, S.L.S., on November 20th, 1992. The plan of survey is filed in the office of the Surveyor General of Saskatchewan, S.I. Hayward, S.L.S., at Regina, Saskatchewan, Canada, under the name of S.I. Hayward, S.L.S., and is subject to the provisions of the Survey Act, R.S.S. 1978, c. S-10, and the regulations thereunder.

Surveyor General of Saskatchewan
 S.I. Hayward, S.L.S.

Team of Kerrobert:
 Signed and sealed on this _____ day of _____, 1992.

 Survey Administrator

Government Road Allowance

East Boundary of N.E. 1/4 Section 10-31-23-3