

Government Road Allowance

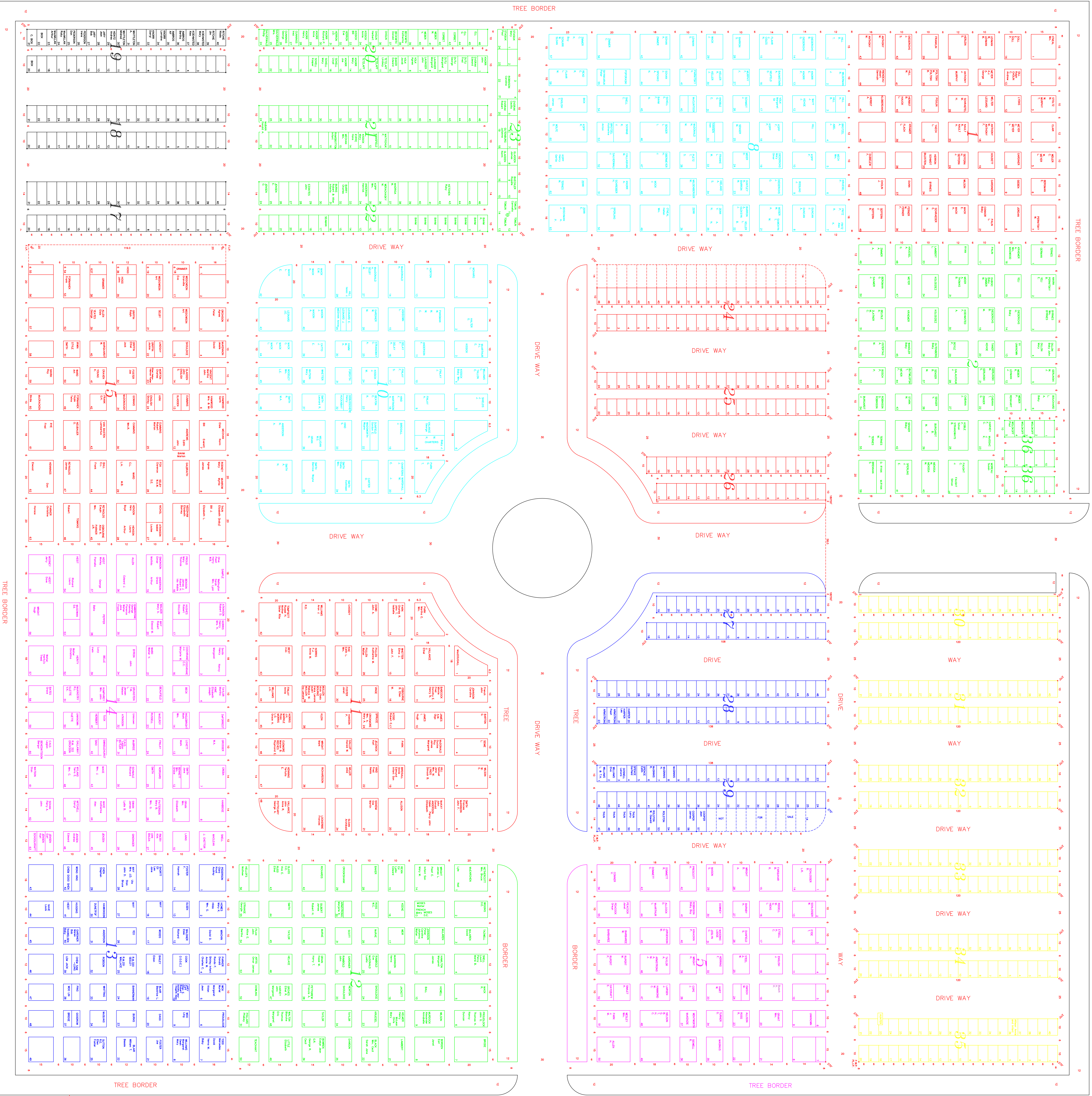

Plan of Survey Showing
 Plot of
KERROBERT CEMETERY
 in
 N.E. 1/4 Sec. 10-31-23-3
 SASKATCHEWAN
 By: S.I. Hayward S.L.S.
 1987 - 1992
 Scale: 1" = 20'

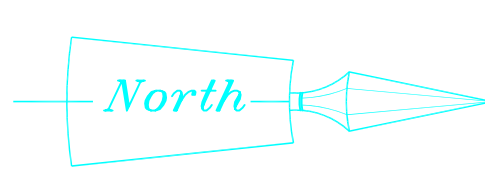

NOTE: This plan was prepared by the Surveyor General of Saskatchewan and is subject to the provisions of the Survey Act, R.S.S. 1978, c. S-24, and the Survey Regulations, S.R.S. 1978, c. S-24/1. The plan was prepared in accordance with the provisions of the Survey Act, R.S.S. 1978, c. S-24, and the Survey Regulations, S.R.S. 1978, c. S-24/1.

Team of Kerrobert:
 Signed and sealed on this _____ day of _____, 1992.

Surveyor
 Team Administrator

Government Road Allowance

East Boundary of N.E. 1/4 Section 10-31-23-3